

LAZY SUSAN INSTRUCTIONS

Note: Patience and dedicated time will be needed for construction.

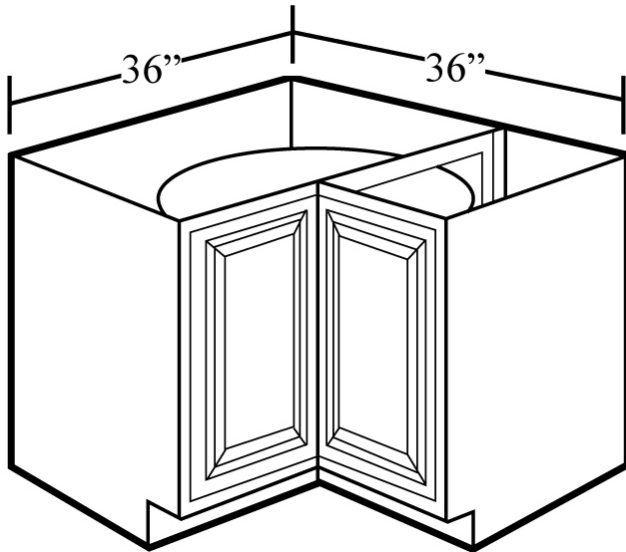

1. Unpack all the components and lay out.
2. Put aside the doors till last.
3. Start with the front door frames and put together. It is helpful if you have someone that can hold these pieces together for you. This will end up looking like a very exaggerated "T" or "L".
4. Now put the left and right sides onto the door frame.
5. Slide the "floor" into place.
6. Install the metal pole down in the center at the bottom only and do not tighten down completely.
7. Adjust pole 'rings' to the height you want the baskets.
8. Slide on basket one. Repeat step 7 and slide on basket two.
9. Attach top of pole to cross support.
10. Test baskets for 'spinning'.
11. Tighten down all screws to the pole now.
12. Attach back side walls.
13. Attach small center back wall.
14. Attach braces at back center wall and top corners.
15. Attach one set of European Hinges to the inside of the cabinet where the doors will go. Do not attach the hinges to the door at this time.
16. Lay your doors face down and attach the European Hinges to the two doors. Do NOT tighten the screws down completely. NOTE: The hinges are compacted together and you can use a flat head screwdriver to 'open' the hinge.
17. Having someone help hold the doors, attach the doors to the European Hinges on the cabinet.
18. Test door for opening and closing.
19. Adjust hinges as needed.
20. Tighten down all screws to the hinges and retest doors.
21. Attach toe kick to bottom of cabinet.